

Alu	Alu > 9% Si	Steel < 1000 N/mm ²	Steel < 1000-1400 N/mm ²	Stainless Steel	Ni-Cr Alloy	GG	GGG	Copper	Brass	Titanium	Plastic
○	○	○	○	●	○	○	○	○	○	○	○

● Optimum ○ Good

VHM DM-21

Z=2

RH



Type-HA



SHRINK FIT



order no	d1 ^{+0.000} / _{-0.004}	l2	l	d	order no	d1 ^{+0.000} / _{-0.004}	l2	l	d
629.010	0.10	0.70	38	3.0	629.045	0.45	3.15	38	3.0
629.011	0.11	0.77	38	3.0	629.046	0.46	3.22	38	3.0
629.012	0.12	0.84	38	3.0	629.047	0.47	3.29	38	3.0
629.013	0.13	0.91	38	3.0	629.048	0.48	3.36	38	3.0
629.014	0.14	0.98	38	3.0	629.049	0.49	3.43	38	3.0
629.015	0.15	1.05	38	3.0	629.050	0.50	3.50	38	3.0
629.016	0.16	1.12	38	3.0	629.051	0.51	3.57	38	3.0
629.017	0.17	1.19	38	3.0	629.052	0.52	3.64	38	3.0
629.018	0.18	1.26	38	3.0	629.053	0.53	3.71	38	3.0
629.019	0.19	1.33	38	3.0	629.054	0.54	3.78	38	3.0
629.020	0.20	1.40	38	3.0	629.055	0.55	3.85	38	3.0
629.021	0.21	1.47	38	3.0	629.056	0.56	3.92	38	3.0
629.022	0.22	1.54	38	3.0	629.057	0.57	3.99	38	3.0
629.023	0.23	1.61	38	3.0	629.058	0.58	4.06	38	3.0
629.024	0.24	1.68	38	3.0	629.059	0.59	4.13	38	3.0
629.025	0.25	1.75	38	3.0	629.060	0.60	4.20	38	3.0
629.026	0.26	1.82	38	3.0	629.061	0.61	4.27	38	3.0
629.027	0.27	1.89	38	3.0	629.062	0.62	4.34	38	3.0
629.028	0.28	1.96	38	3.0	629.063	0.63	4.41	38	3.0
629.029	0.29	2.03	38	3.0	629.064	0.64	4.48	38	3.0
629.030	0.30	2.10	38	3.0	629.065	0.65	4.55	38	3.0
629.031	0.31	2.17	38	3.0	629.066	0.66	4.62	38	3.0
629.032	0.32	2.24	38	3.0	629.067	0.67	4.69	38	3.0
629.033	0.33	2.31	38	3.0	629.068	0.68	4.76	38	3.0
629.034	0.34	2.38	38	3.0	629.069	0.69	4.83	38	3.0
629.035	0.35	2.45	38	3.0	629.070	0.70	4.90	38	3.0
629.036	0.36	2.52	38	3.0	629.071	0.71	4.97	38	3.0
629.037	0.37	2.59	38	3.0	629.072	0.72	5.04	38	3.0
629.038	0.38	2.66	38	3.0	629.073	0.73	5.11	38	3.0
629.039	0.39	2.73	38	3.0	629.074	0.74	5.18	38	3.0
629.040	0.40	2.80	38	3.0	629.075	0.75	5.25	38	3.0
629.041	0.41	2.87	38	3.0	629.076	0.76	5.32	38	3.0
629.042	0.42	2.94	38	3.0	629.077	0.77	5.39	38	3.0
629.043	0.43	3.01	38	3.0	629.078	0.78	5.46	38	3.0
629.044	0.44	3.08	38	3.0	629.079	0.79	5.53	38	3.0

- DIAMETER TOLERANCE IS BEFORE COATING
- EDGE PREPARATION ON REQUEST
- COATING ON REQUEST
- LASER MARKING ON REQUEST
- SPECIAL DIAMETERS & LENGTHS ON REQUEST

629 UNIDRILL

6 x d1

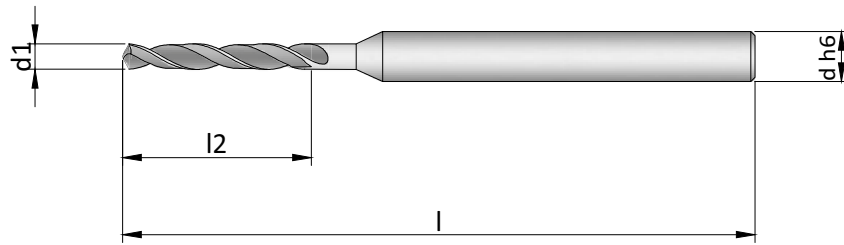
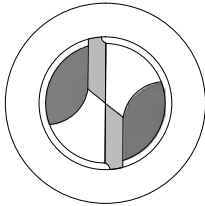

Alu	Alu > 9% Si	Steel < 1000 N/mm ²	Steel < 1000-1400 N/mm ²	Stainless Steel	Ni-Cr Alloy	GG	GGG	Copper	Brass	Titanium	Plastic
<input type="radio"/>	<input type="radio"/>	<input type="radio"/>	<input type="radio"/>	<input checked="" type="radio"/>	<input type="radio"/>	<input type="radio"/>	<input type="radio"/>	<input type="radio"/>	<input type="radio"/>	<input type="radio"/>	<input type="radio"/>

● Optimum ○ Good

order no	d1 ^{+0.000 -0.004}	l2	l	d	order no	d1 ^{+0.000 -0.004}	l2	l	d
629.080	0.80	5.60	38	3.0	629.115	1.15	8.05	38	3.0
629.081	0.81	5.67	38	3.0	629.116	1.16	8.12	38	3.0
629.082	0.82	5.74	38	3.0	629.117	1.17	8.19	38	3.0
629.083	0.83	5.81	38	3.0	629.118	1.18	8.26	38	3.0
629.084	0.84	5.88	38	3.0	629.119	1.19	8.33	38	3.0
629.085	0.85	5.95	38	3.0	629.120	1.20	8.40	38	3.0
629.086	0.86	6.02	38	3.0	629.121	1.21	8.47	38	3.0
629.087	0.87	6.09	38	3.0	629.122	1.22	8.54	38	3.0
629.088	0.88	6.16	38	3.0	629.123	1.23	8.61	38	3.0
629.089	0.89	6.23	38	3.0	629.124	1.24	8.68	38	3.0
629.090	0.90	6.30	38	3.0	629.125	1.25	8.75	38	3.0
629.091	0.91	6.37	38	3.0	629.126	1.26	8.82	38	3.0
629.092	0.92	6.44	38	3.0	629.127	1.27	8.89	38	3.0
629.093	0.93	6.51	38	3.0	629.128	1.28	8.96	38	3.0
629.094	0.94	6.58	38	3.0	629.129	1.29	9.03	38	3.0
629.095	0.95	6.65	38	3.0	629.130	1.30	9.10	38	3.0
629.096	0.96	6.72	38	3.0	629.131	1.31	9.17	38	3.0
629.097	0.97	6.79	38	3.0	629.132	1.32	9.24	38	3.0
629.098	0.98	6.86	38	3.0	629.133	1.33	9.31	38	3.0
629.099	0.99	6.93	38	3.0	629.134	1.34	9.38	38	3.0
629.100	1.00	7.00	38	3.0	629.135	1.35	9.45	38	3.0
629.101	1.01	7.07	38	3.0	629.136	1.36	9.52	38	3.0
629.102	1.02	7.14	38	3.0	629.137	1.37	9.59	38	3.0
629.103	1.03	7.21	38	3.0	629.138	1.38	9.66	38	3.0
629.104	1.04	7.28	38	3.0	629.139	1.39	9.73	38	3.0
629.105	1.05	7.35	38	3.0	629.140	1.40	9.80	38	3.0
629.106	1.06	7.42	38	3.0	629.141	1.41	9.87	38	3.0
629.107	1.07	7.49	38	3.0	629.142	1.42	9.94	38	3.0
629.108	1.08	7.56	38	3.0	629.143	1.43	10.01	38	3.0
629.109	1.09	7.63	38	3.0	629.144	1.44	10.08	38	3.0
629.110	1.10	7.70	38	3.0	629.145	1.45	10.15	38	3.0
629.111	1.11	7.77	38	3.0	629.146	1.46	10.22	38	3.0
629.112	1.12	7.84	38	3.0	629.147	1.47	10.29	38	3.0
629.113	1.13	7.91	38	3.0	629.148	1.48	10.36	38	3.0
629.114	1.14	7.98	38	3.0	629.149	1.49	10.43	38	3.0

VHM DM-21

Z=2

RH

30° HELIX

6 x d1

120°

< Ø0.40

≥ Ø0.40

Type-HA

SHRINK FIT

Water spray icon

Flute profile icon

- DIAMETER TOLERANCE IS BEFORE COATING
- EDGE PREPARATION ON REQUEST
- COATING ON REQUEST
- LASER MARKING ON REQUEST
- SPECIAL DIAMETERS & LENGTHS ON REQUEST

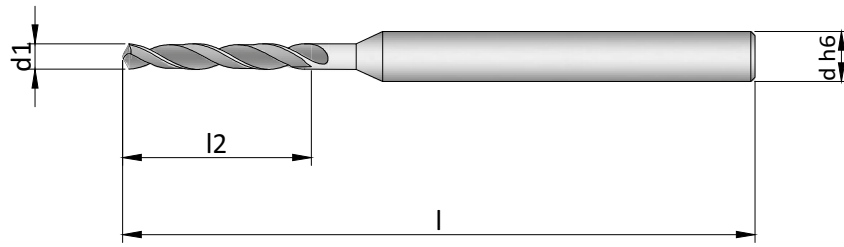
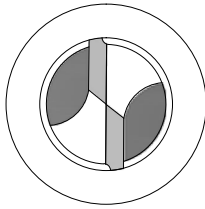

Alu	Alu > 9% Si	Steel < 1000 N/mm ²	Steel < 1000-1400 N/mm ²	Stainless Steel	Ni-Cr Alloy	GG	GGG	Copper	Brass	Titanium	Plastic
○	○	○	○	●	○	○	○	○	○	○	○

● Optimum ○ Good

VHM DM-21

Z=2

RH



Type-HA



SHRINK FIT



order no	d1 ^{+0.000/-0.004}	l2	l	d
629.150	1.50	10.50	38	3.0
629.151	1.51	10.57	38	3.0
629.152	1.52	10.64	38	3.0
629.153	1.53	10.71	38	3.0
629.154	1.54	10.78	38	3.0
629.155	1.55	10.85	38	3.0
629.156	1.56	10.92	38	3.0
629.157	1.57	10.99	38	3.0
629.158	1.58	11.06	38	3.0
629.159	1.59	11.13	38	3.0
629.160	1.60	11.20	38	3.0
629.161	1.61	11.27	38	3.0
629.162	1.62	11.34	38	3.0
629.163	1.63	11.41	38	3.0
629.164	1.64	11.48	38	3.0
629.165	1.65	11.55	38	3.0
629.166	1.66	11.62	38	3.0
629.167	1.67	11.69	38	3.0
629.168	1.68	11.76	38	3.0
629.169	1.69	11.83	38	3.0
629.170	1.70	11.90	38	3.0
629.171	1.71	11.97	38	3.0
629.172	1.72	12.04	38	3.0
629.173	1.73	12.11	38	3.0
629.174	1.74	12.18	38	3.0
629.175	1.75	12.25	38	3.0
629.176	1.76	12.32	38	3.0
629.177	1.77	12.39	38	3.0
629.178	1.78	12.46	38	3.0
629.179	1.79	12.53	38	3.0
629.180	1.80	12.60	38	3.0
629.181	1.81	12.67	38	3.0
629.182	1.82	12.74	38	3.0
629.183	1.83	12.81	38	3.0
629.184	1.84	12.88	38	3.0

order no	d1 ^{+0.000/-0.004}	l2	l	d
629.185	1.85	12.95	38	3.0
629.186	1.86	13.02	38	3.0
629.187	1.87	13.09	38	3.0
629.188	1.88	13.16	38	3.0
629.189	1.89	13.23	38	3.0
629.190	1.90	13.30	38	3.0
629.191	1.91	13.37	38	3.0
629.192	1.92	13.44	38	3.0
629.193	1.93	13.51	38	3.0
629.194	1.94	13.58	38	3.0
629.195	1.95	13.65	38	3.0
629.196	1.96	13.72	38	3.0
629.197	1.97	13.79	38	3.0
629.198	1.98	13.86	38	3.0
629.199	1.99	13.93	38	3.0
629.200	2.00	14.00	38	3.0

- DIAMETER TOLERANCE IS BEFORE COATING
- EDGE PREPARATION ON REQUEST
- COATING ON REQUEST
- LASER MARKING ON REQUEST
- SPECIAL DIAMETERS & LENGTHS ON REQUEST